









Betriebsanleitung
Operating Instructions
Instructions de service
Istruzioni d'uso
Handleiding
Instrucciones para el manejo
Manual de instruções
Naudojimosi instrukcija
Kasutusjuhend
Lietošanas instrukcija
Driftsinstruks
Driftsinstruktioner
Käyttöohje
Driftsvejledning
Instrukcja obsługi

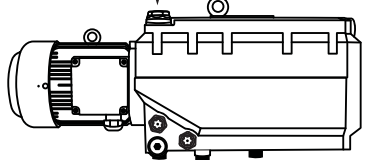

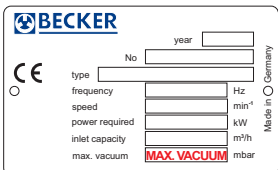

Kezelési útmutató
Návod k obsluze
Navodilo za uporabo
Návod na obsluhu
Upute za rad
Manual de operatii
Teoracha Oibriúcháin
Οδηγίες χρήσης
El Kitabi
Инструкции за експлоатация
Инструкция по эксплуатации
取扱説明書
사용설명서
使用说明书

U 4.70

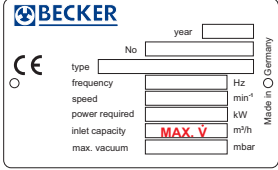
2006/42/EG

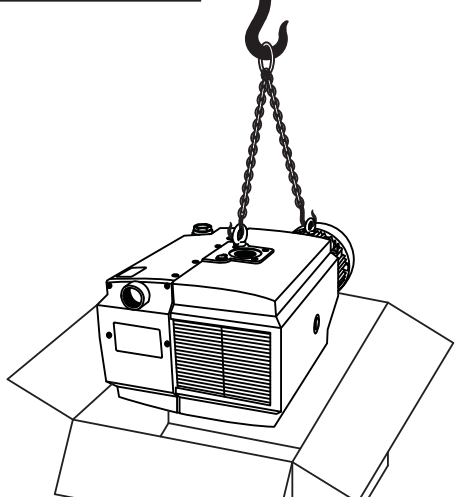

 	 Becker Lube M/S/SL 100 ▷ 2,0 Liter	 MAX. VACUUM	 mbar	
 AIR	 	 	 MAX. DIN EN ISO 3744	 m³/h L _{pA} = 67 dB(A) - 50Hz L _{pA} = 68,5 dB(A) - 60Hz K _{pA} = 3 dB(A)

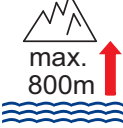
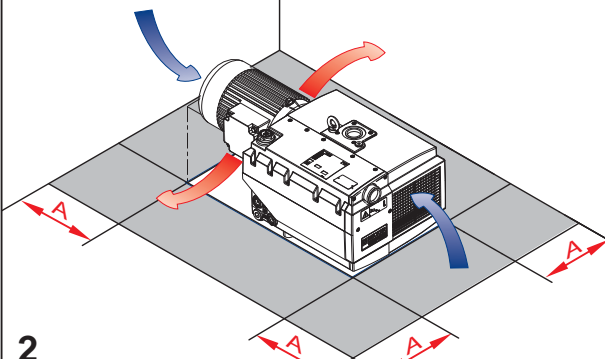
 64,5 kg 142,2 lbs	 	A > 100mm A > 4" > 5°C/41°F < 40°C/104°F	 max. 90%	 max. 800m 
---	--	---	---	--

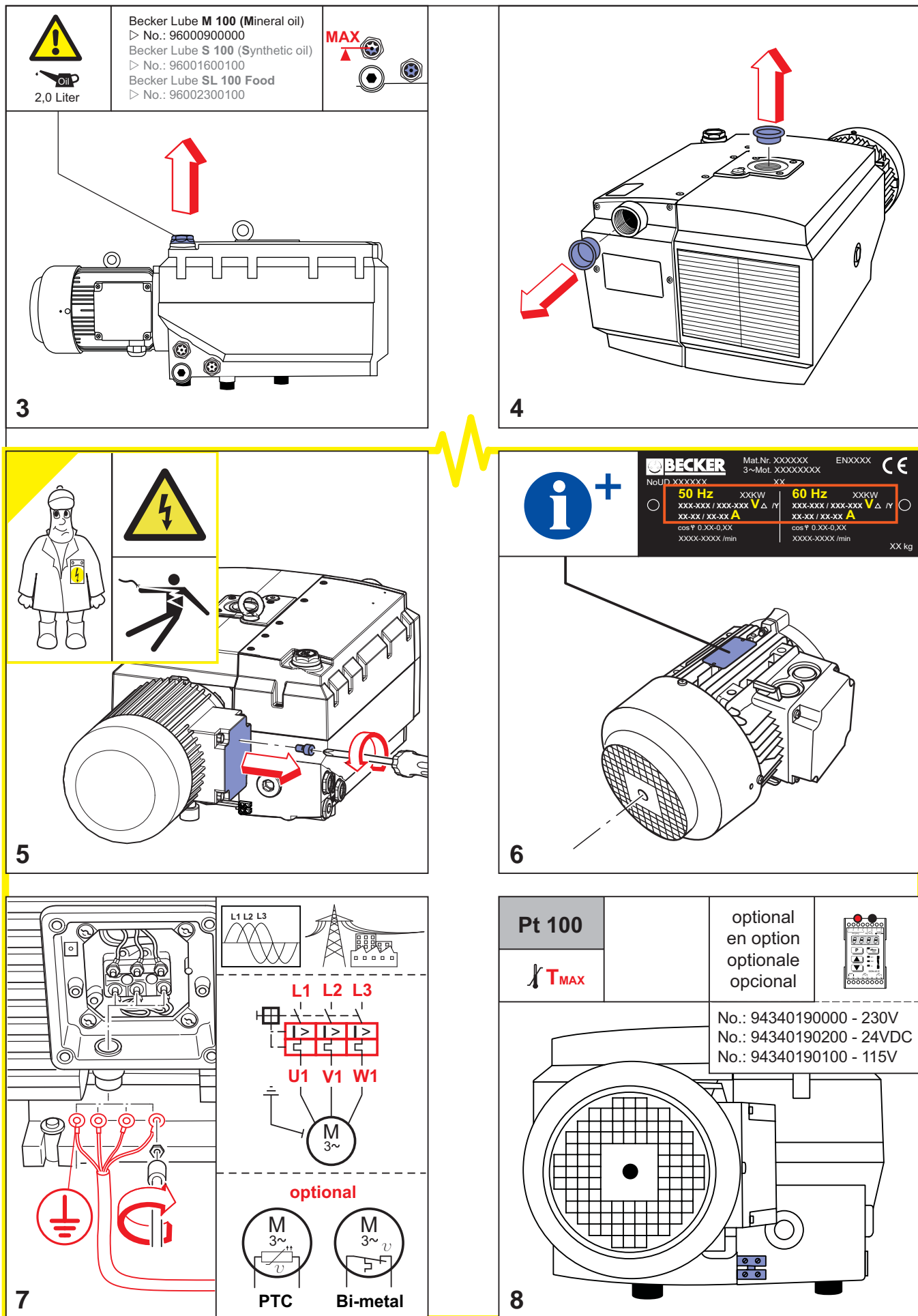

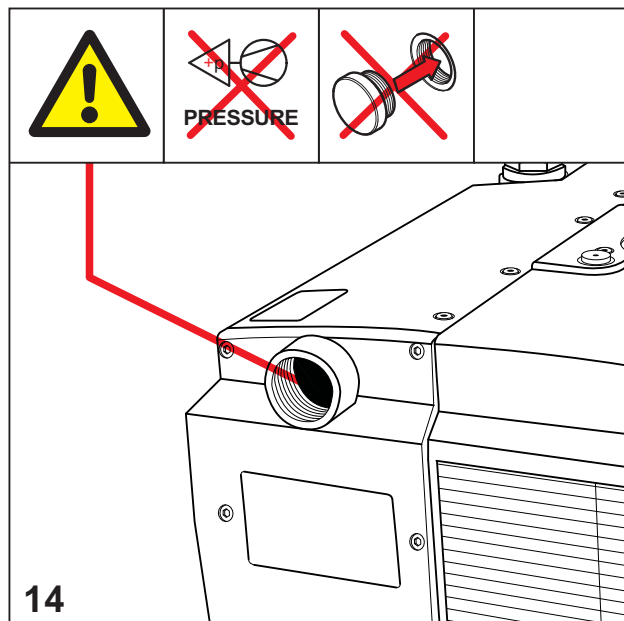
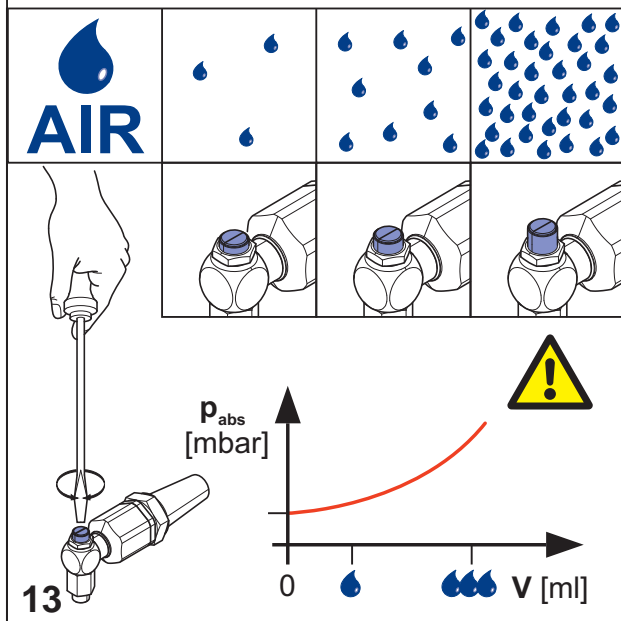
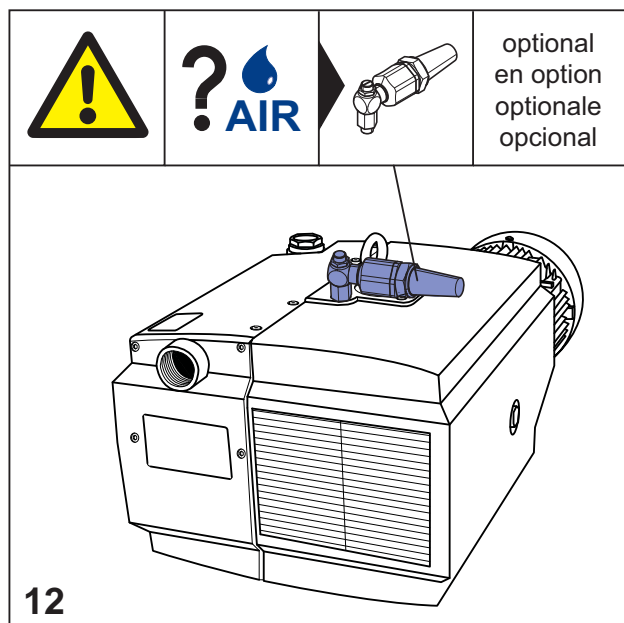
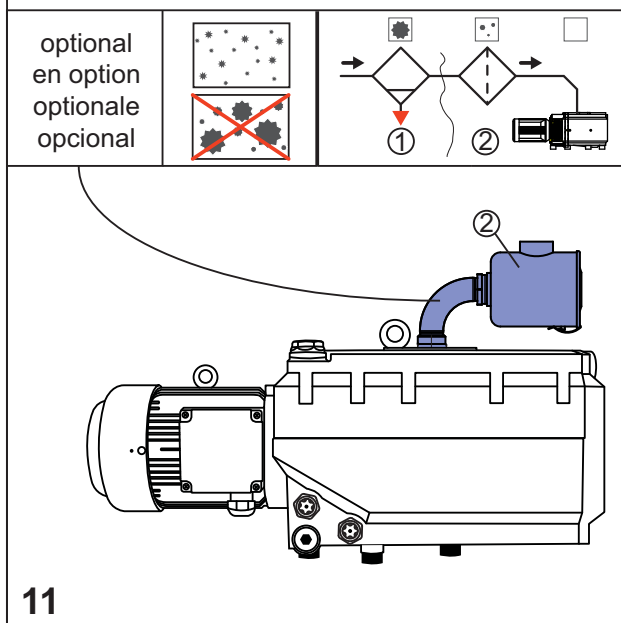
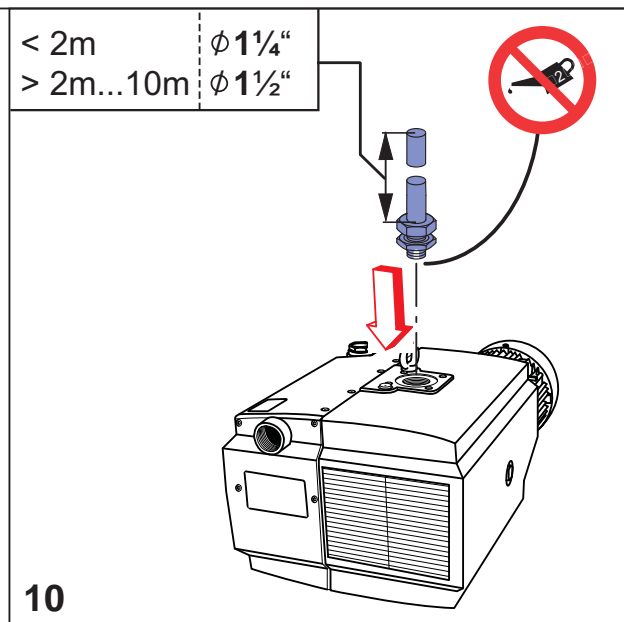
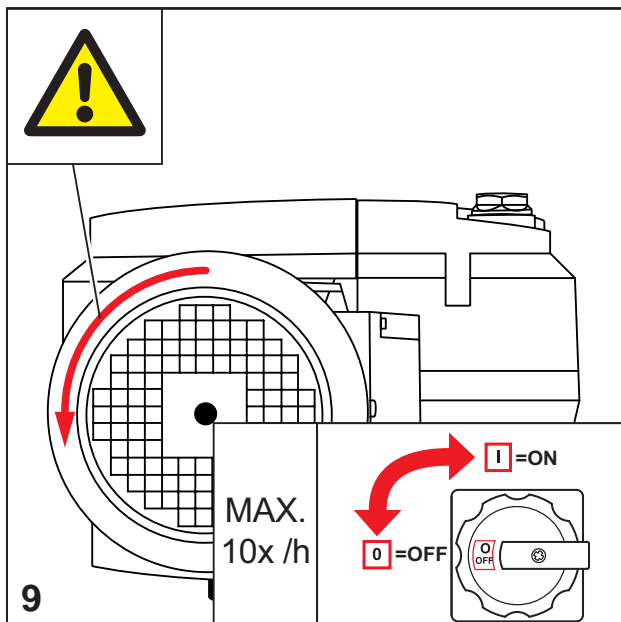

<p>A.</p>		 	<p>n=0min⁻¹</p>
 <p>40 h</p>	 <p>Becker Lube M/S/SL 100</p>		
<p>C.</p>		<p>D.</p>	
	 	 <p>▷ 2,0 Liter</p>	<p>Becker Lube M 100 (Mineral oil) ▷ No.: 96000900000 Becker Lube S 100 (Synthetic oil) ▷ No.: 96001600100 Becker Lube SL 100 Food ▷ No.: 96002300100</p>
<p>E.</p>		<p>F.</p>	

